

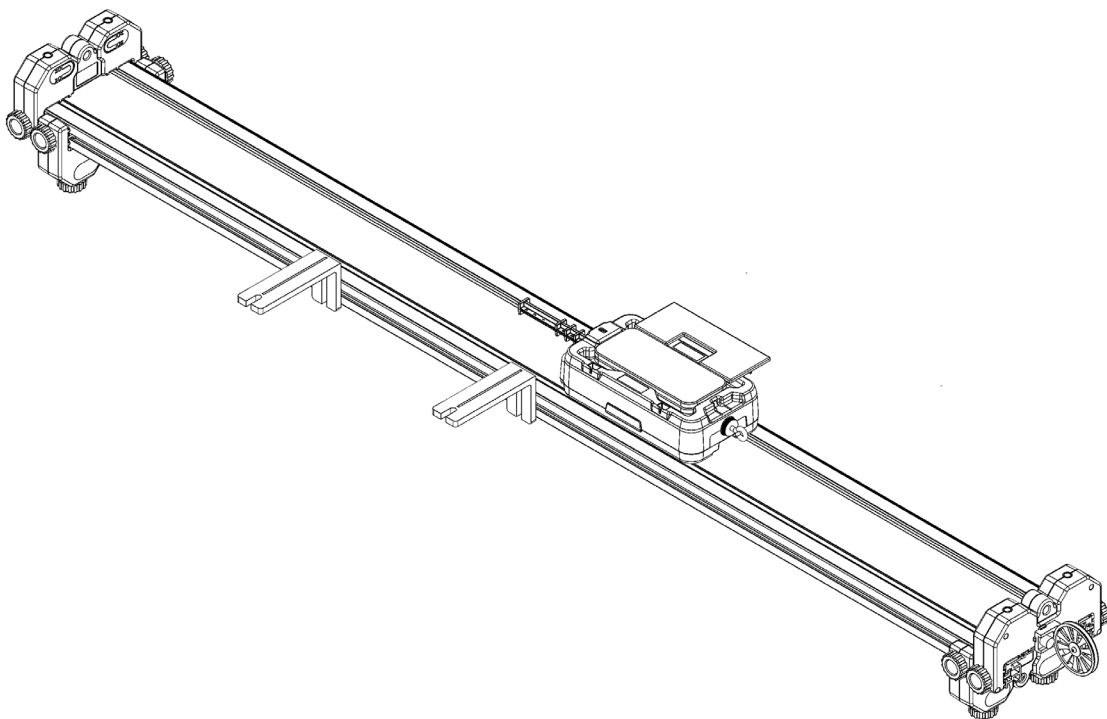

DYNAMICS TRACK & ACCESSORIES ASSEMBLY GUIDE



Components

Ensure you have all components prior to assembly.

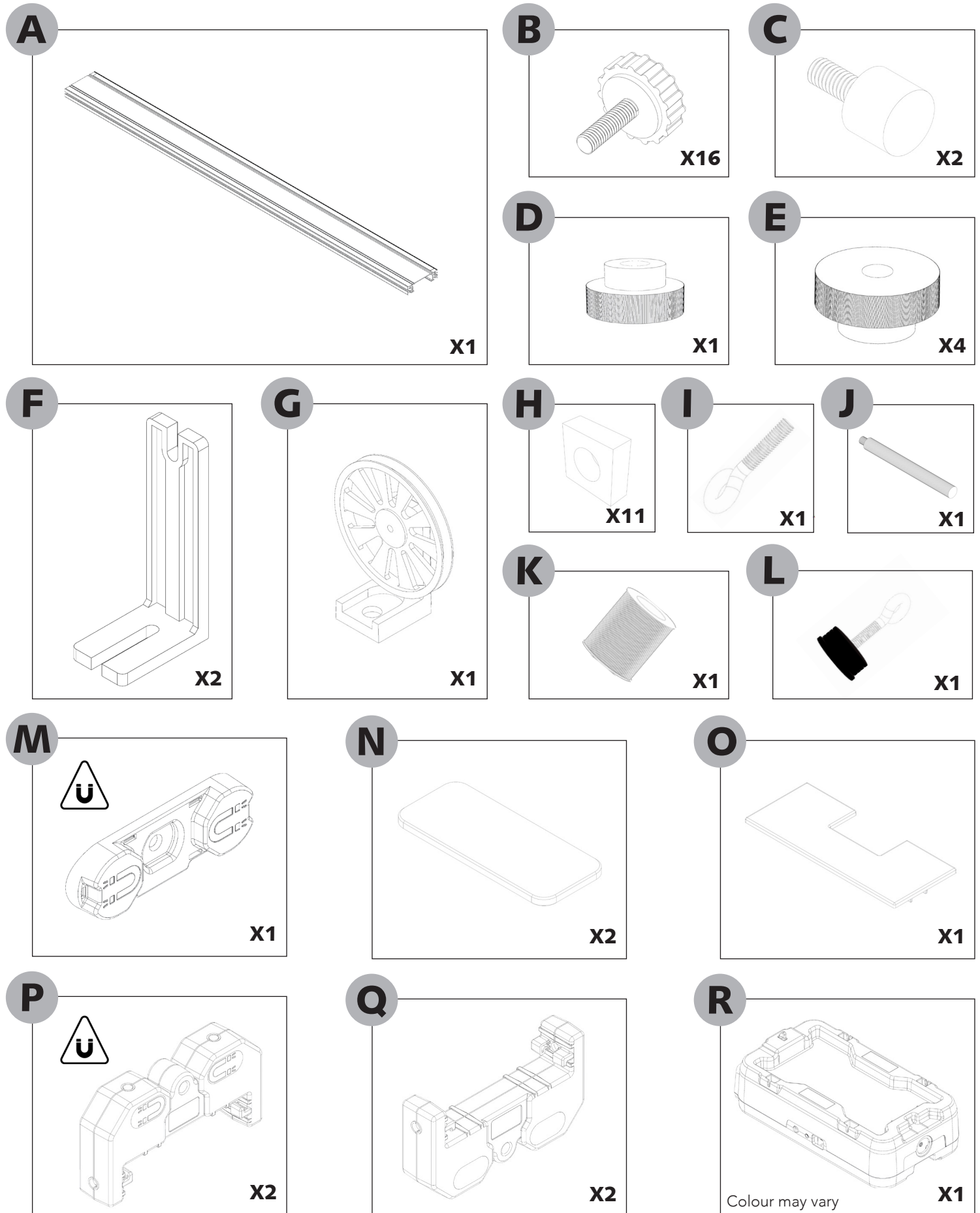

Leveling Foot Assembly x 2

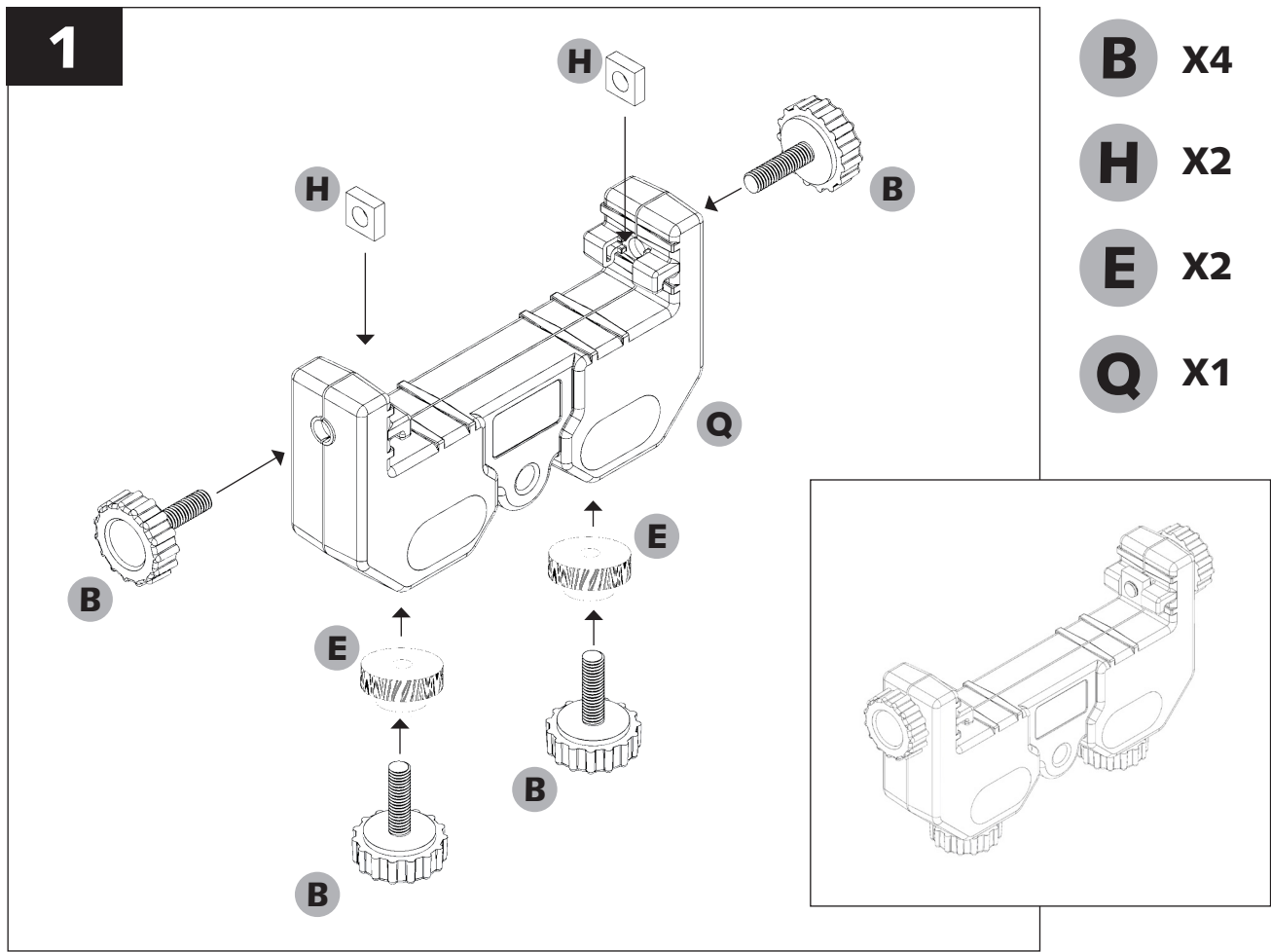

Attach each leveling foot to either end of track

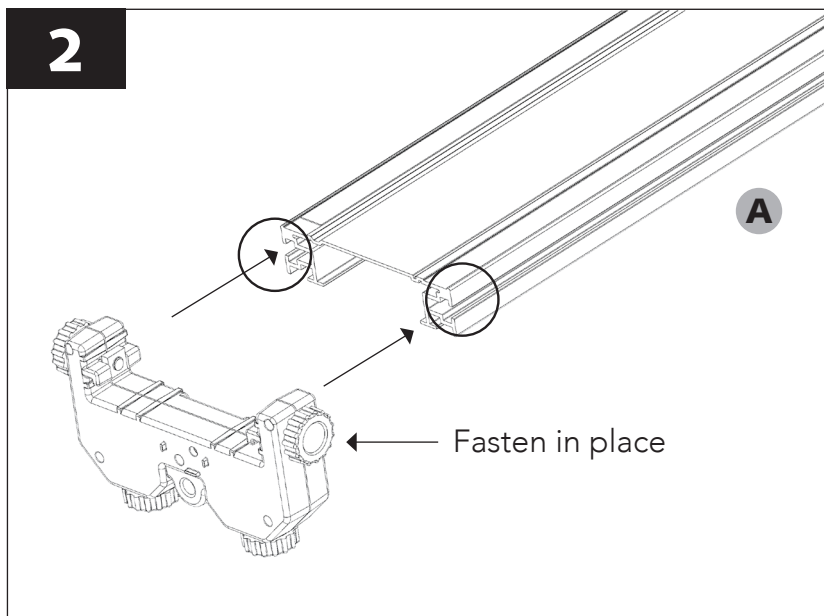

Magnetic Endstop Assembly x 2

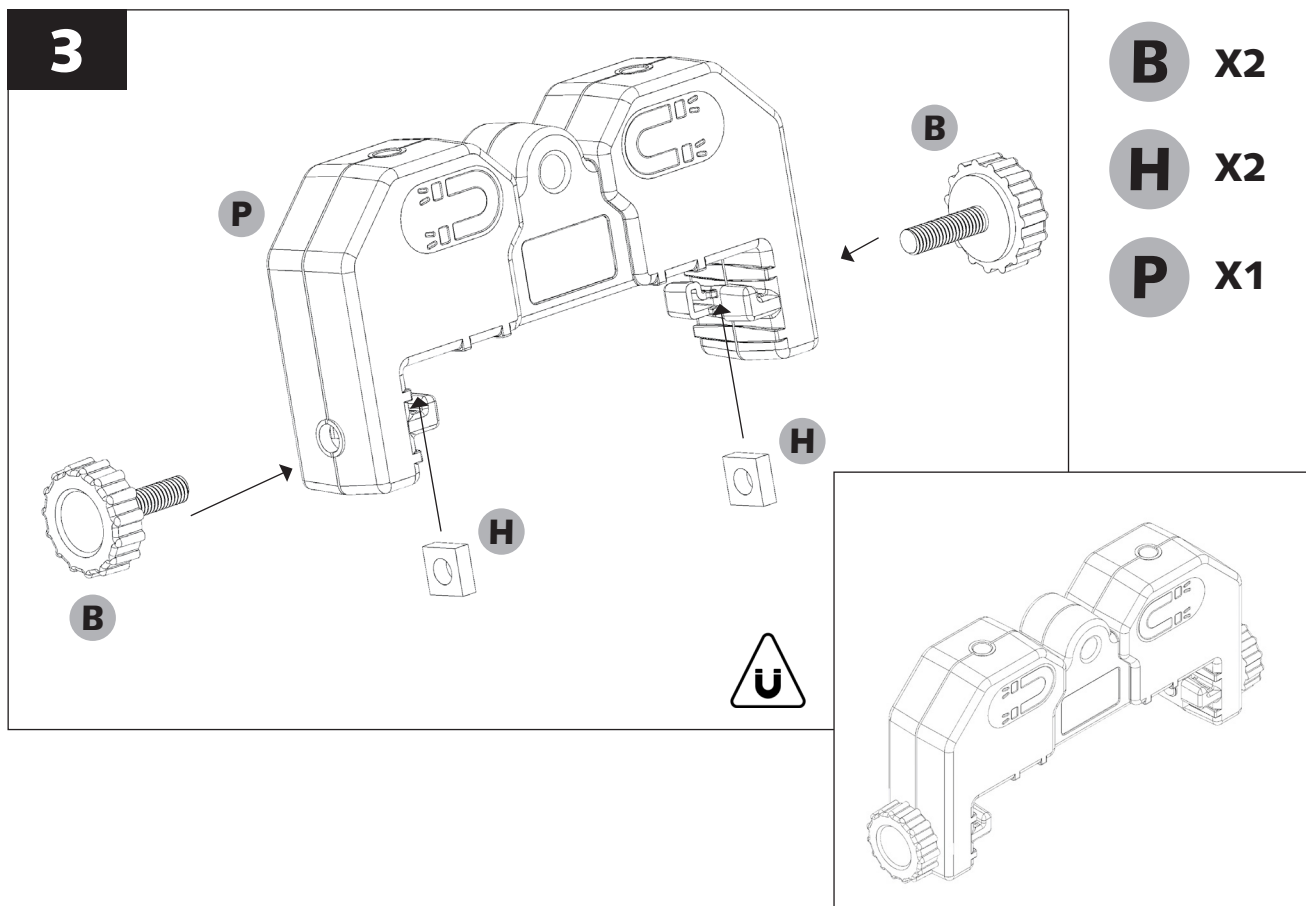

Attach each magnetic endstop to either end of track

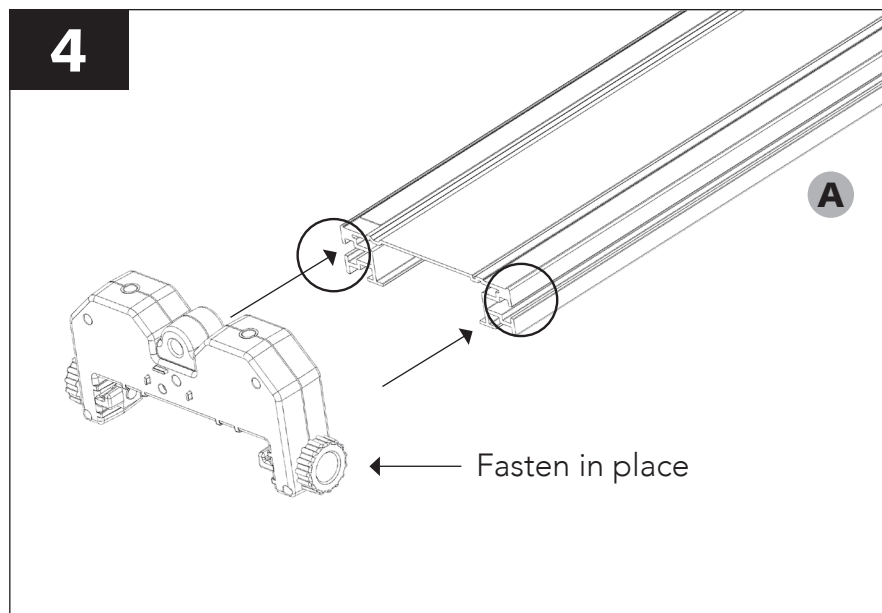

Level track before use

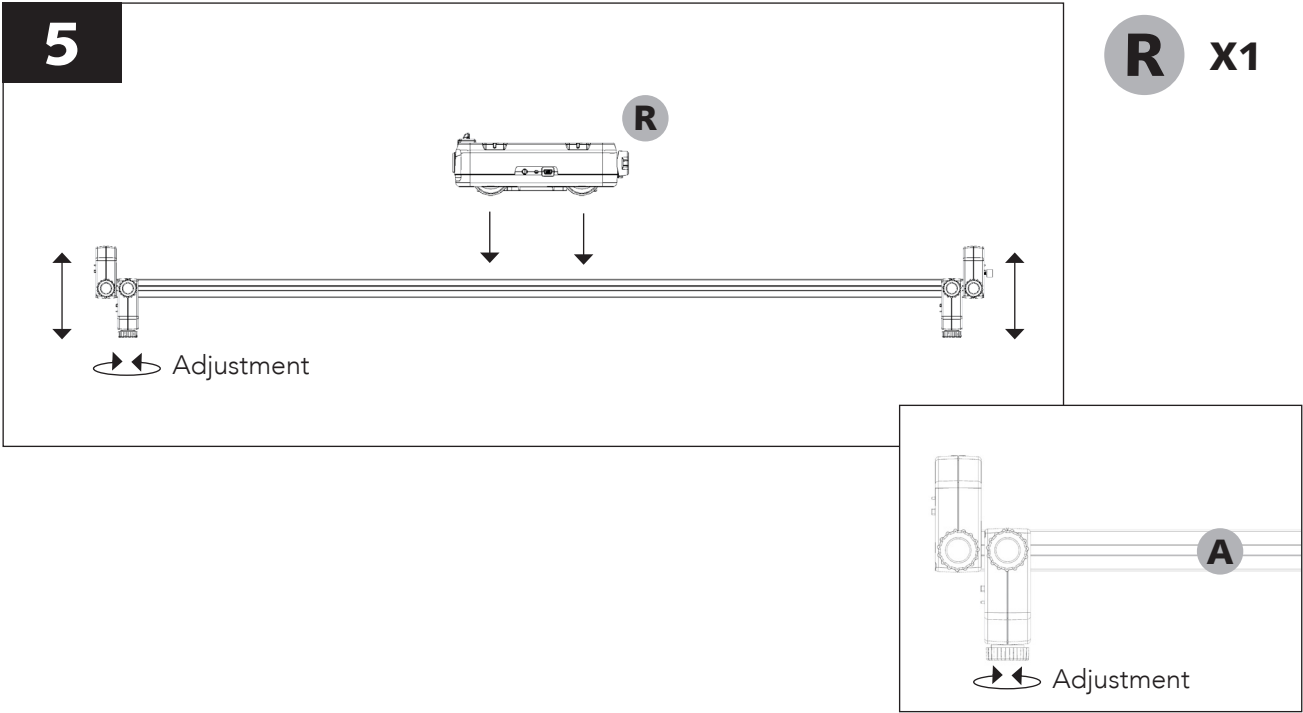

Magnetic Bumper Assembly (optional)

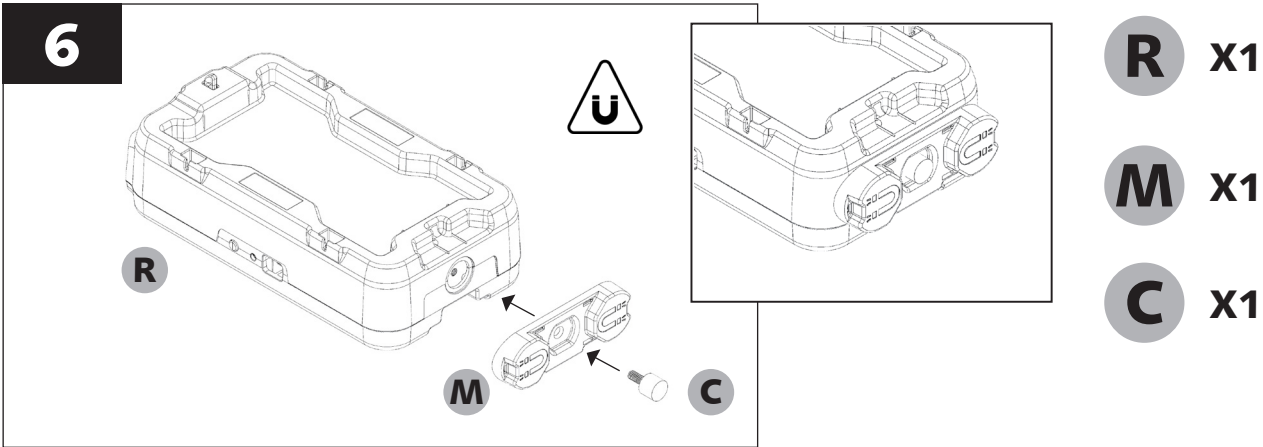

Hook Assembly (optional)

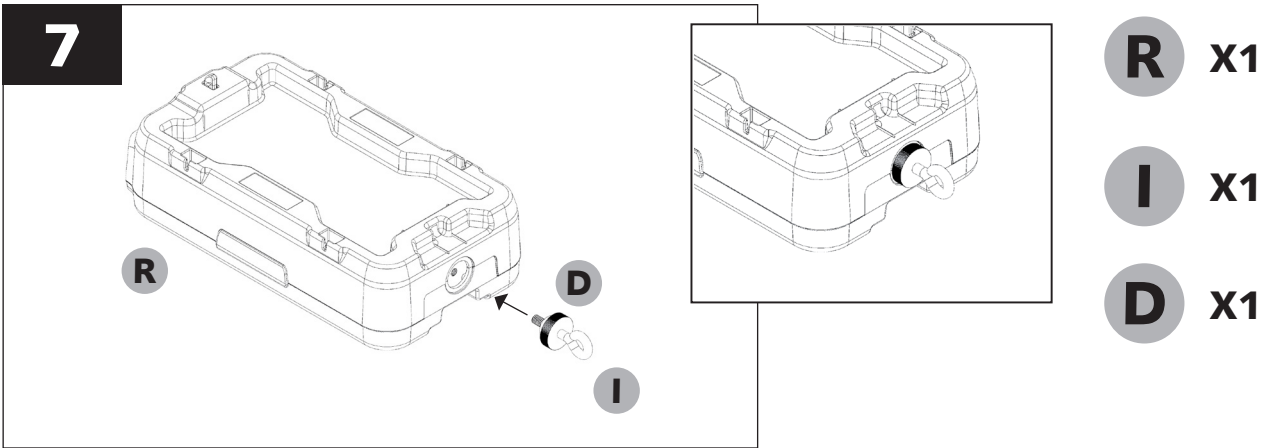

Mass Placement (optional)

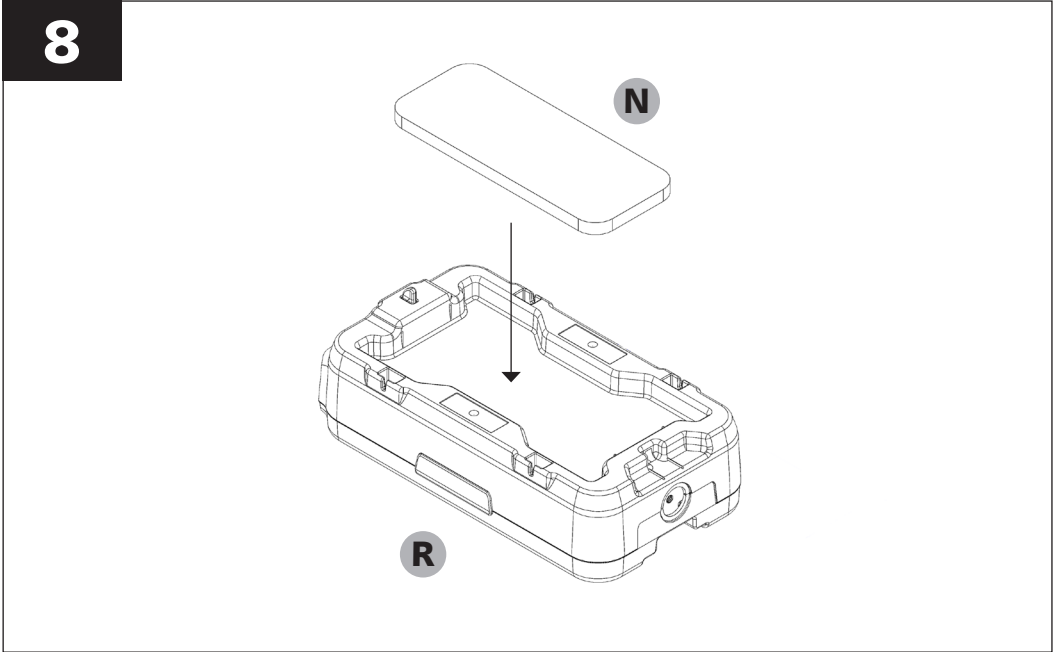

R x1

N x1

Cart Placement (optional)

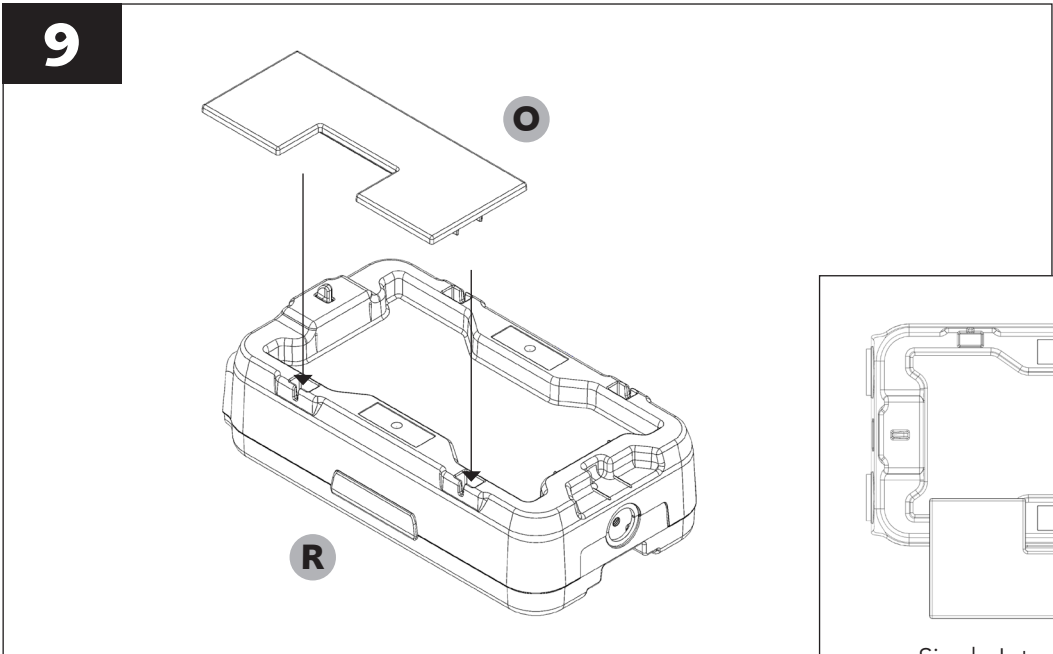

R x1

O x1

Can be fitted to either side of the cart

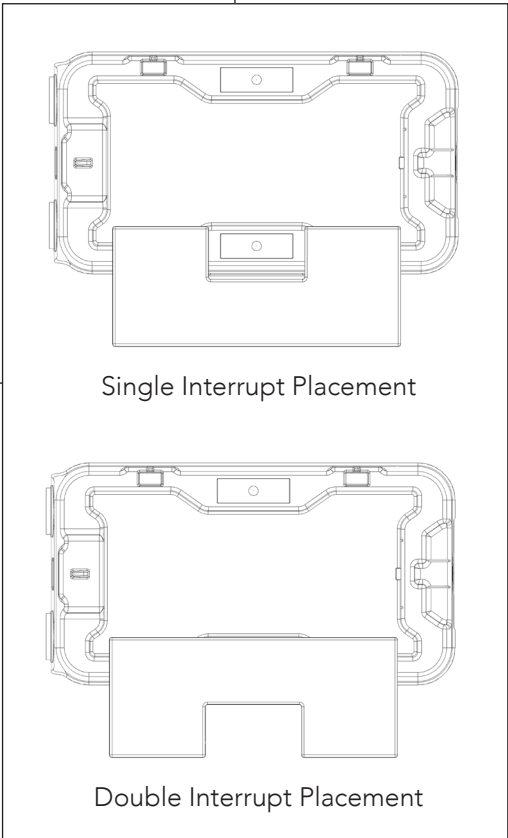

Spoked Pulley Assembly (optional)

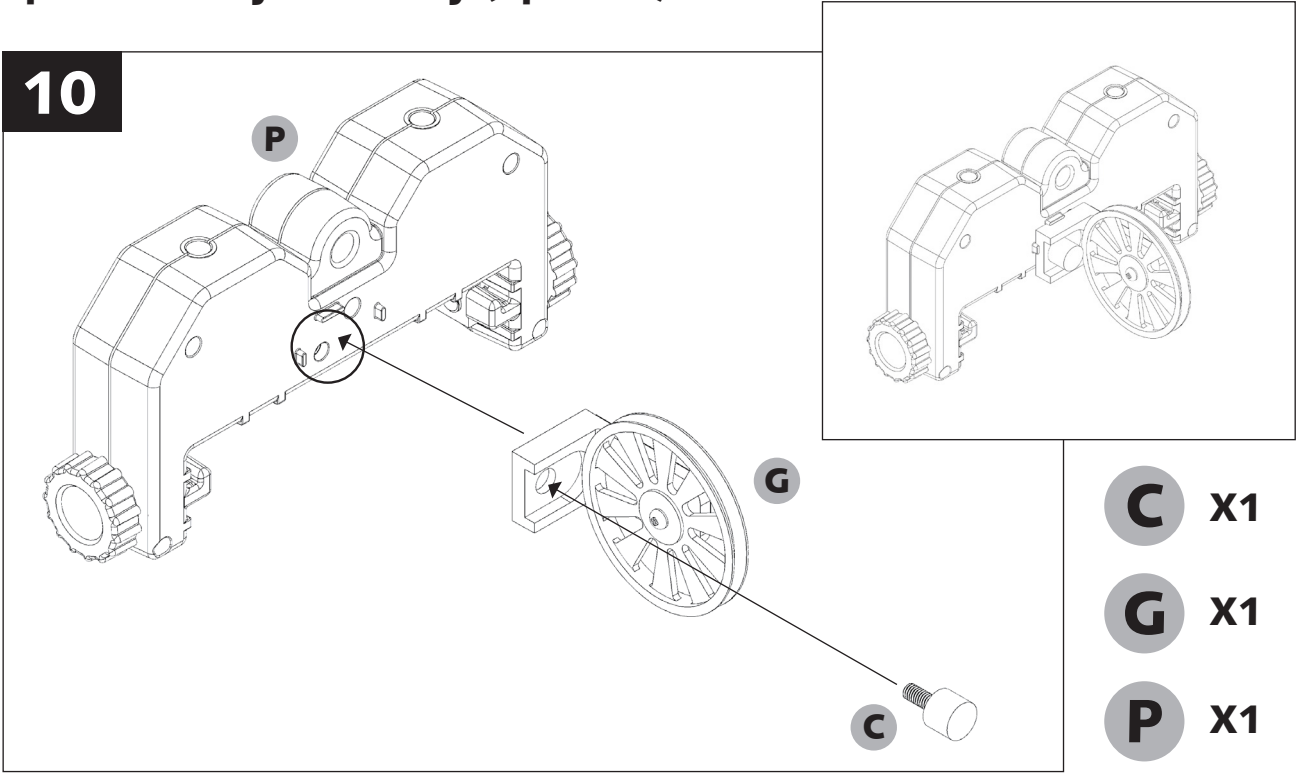

Light Gate Assembly (optional)

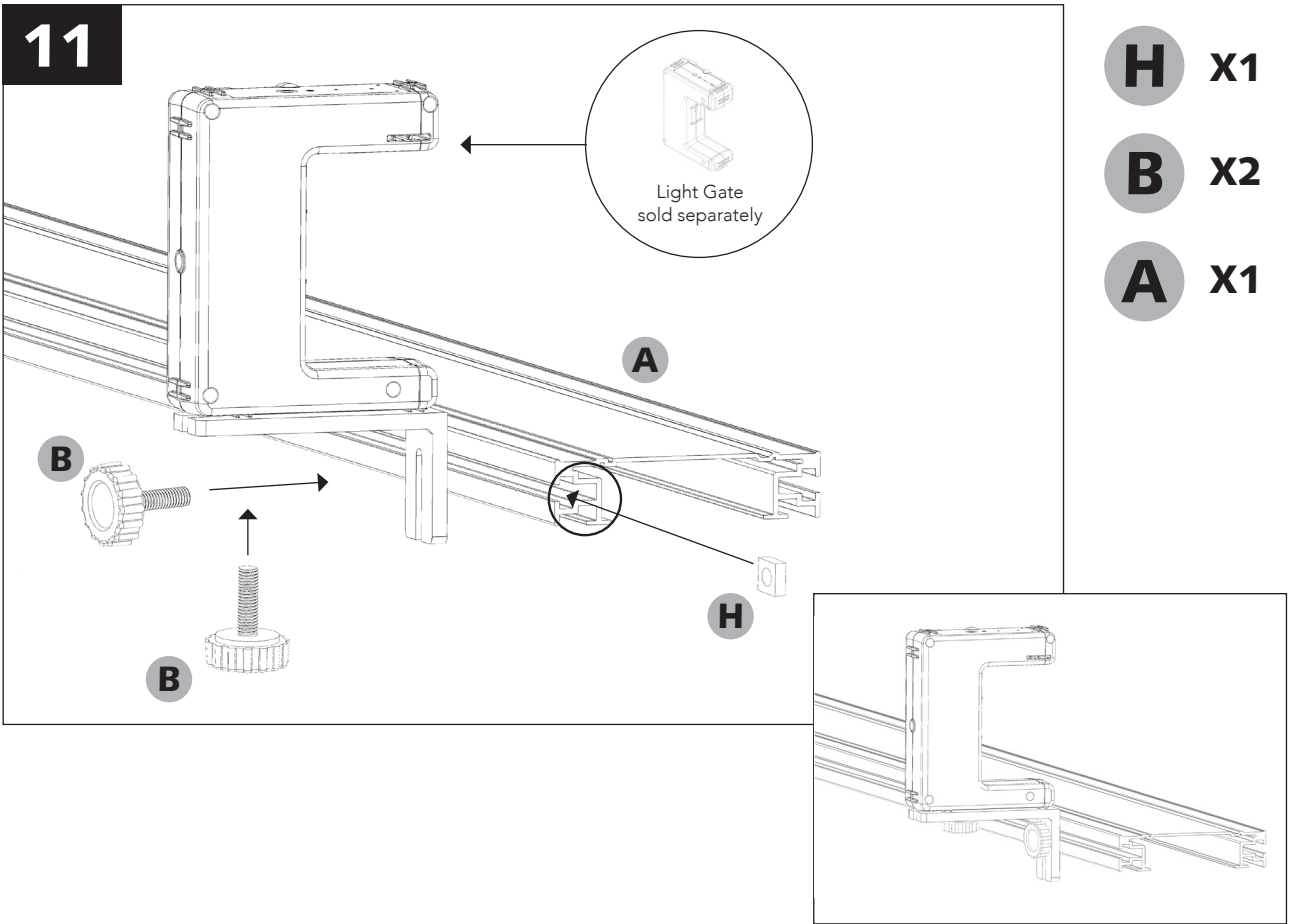

Rod Assembly (optional)

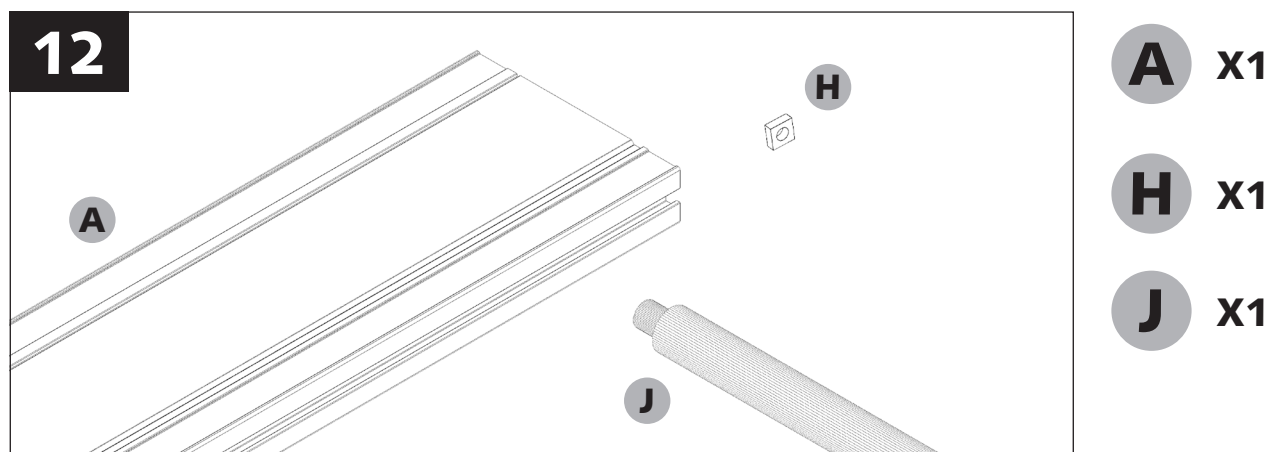

Compliance Information

This product complies to the following standards:



CE

This product conforms to the CE specification. It has been assessed and deemed to meet EU safety, health and environmental protection requirements as required for products manufactured anywhere in the world that are then marketed within the EU.



CAUTION - Magnetic Parts

This product contains strong magnetic parts as indicated with this icon and must be used as illustrated as per these assembly instructions. Do not dismatle.